



PUREPLAZA.COM

  
**ZIA ABBAS**  
www.CondoOnly.com



**WORLD CLASS**  
www.WorldClassRealtyPoint.com  
**REALTY POINT**  
BROKERAGE  
Independently Owned & Operated  
(416) 444.7653

**PLAZA MIDTOWN**  
YONGE & EGLINTON



**WORLD CLASS REALTY POINT**  
 BROKERAGE  
 Independently Owned & Operated  
 www.WorldClassRealtyPoint.com  
 (416) 444-6653

## THE CENTRE OF THE ACTION

Located at sought-after Yonge and Eglinton, the Plaza Midtown represents the best of both worlds – efficient and well connected with access anywhere in the city, yet completely self-contained, an enclave unto itself.

It's a neighbourhood rapidly evolving into the future.

Two buildings on one site leveraging existing structures, the Plaza Midtown declares ownership of midtown Toronto, a reflection of Eglinton's uniquely piecemeal history, evolving organically to suit the influx of area inhabitants.

This is the new midtown. This is Plaza Midtown.



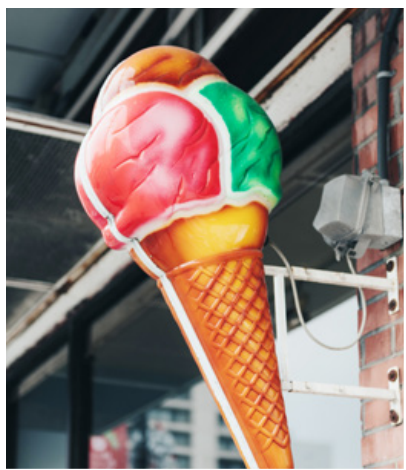

THE NEW MIDTOWN.



1. Cibo Wine Bar
2. L'Occitane en Provence
3. de Mello Palheta Coffee Roasters
4. Darbar Persian Grill
5. South St. Burger
6. Roberto's Italian Bistro
7. Sporting Life
8. Absolute Comedy Club
9. Yonge-Eglinton Centre
10. Village Juicery

01

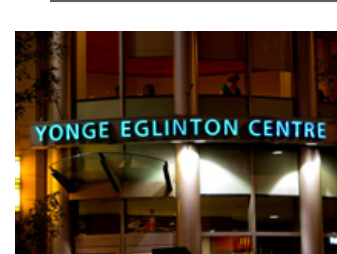

09

02



05



07



PLAZA®

PLAZA MIDTOWN  
YONGE & EGLINTON

WORLD REALTY POINT  
CLASSIFIED BROKERS AG & Co.  
www.WorldClassRealtyPoint.com  
(416) 444-7653



## GET AROUND.

THE FUTURE LRT PLACES PLAZA MIDTOWN AT THE CENTRE OF EVERYTHING.

With a Walk Score of 98, Yonge and Eglinton's impressive daily foot traffic tops an estimated 80,000 pedestrians daily - rivalled only by Toronto's Yonge and Dundas Square. It's already a walker's paradise, but soon, with the imminent Crosstown LRT, the intersection will be even more accessible than ever before. By foot, by train, by car – you decide.



ZIA ABBAS  
www.CondoOnly.com

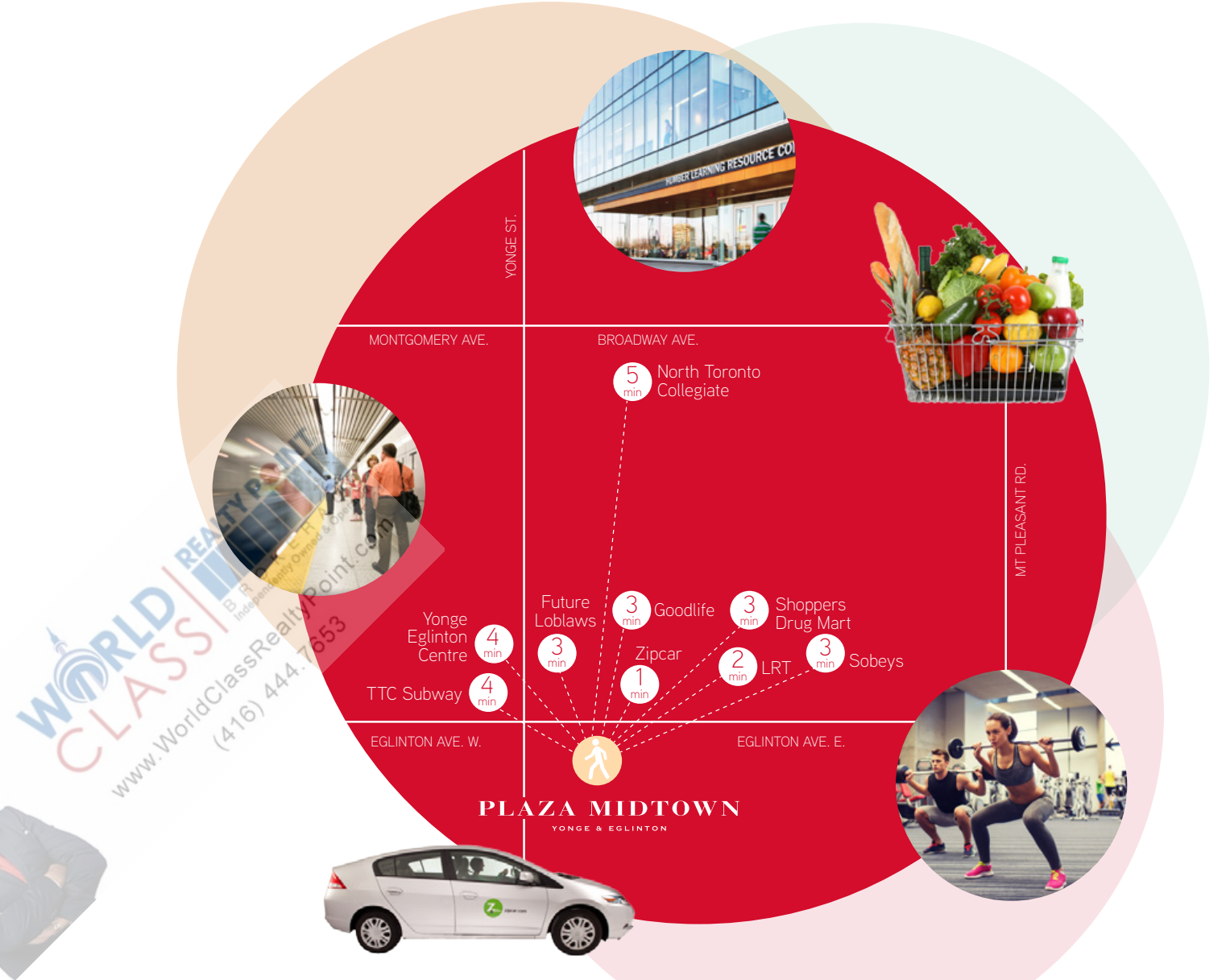

WALKER'S PARADISE  
WALK SCORE:

# 98

When completed in 2020, the 19km LRT will significantly cut travel time, while linking to 54 local bus routes, three subway interchanges and GO Transit.

It means getting to the Eaton Centre in just 20 minutes, Union Station in 24, and Pearson International Airport in as little as 45.

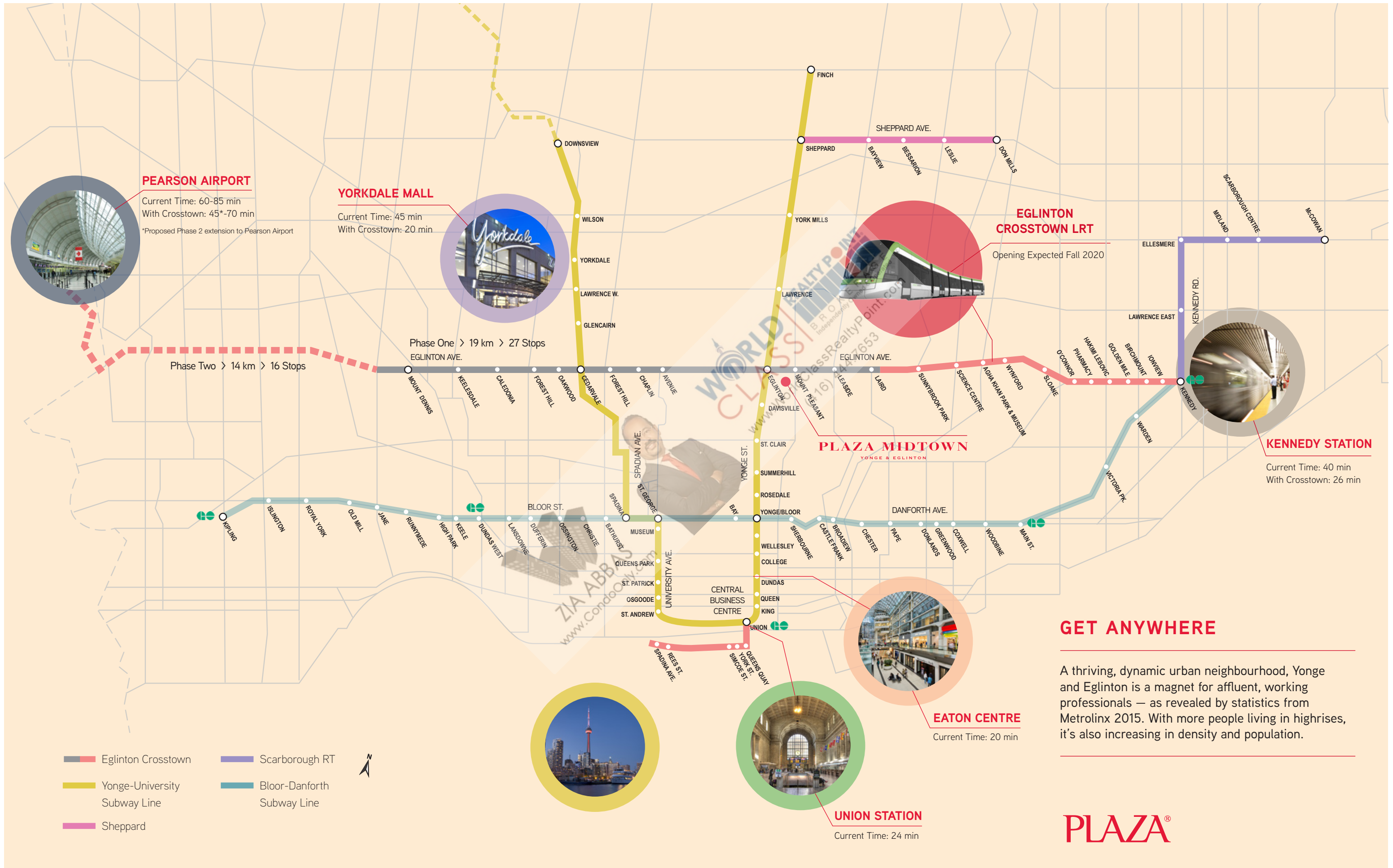

## GET ANYWHERE

A thriving, dynamic urban neighbourhood, Yonge and Eglinton is a magnet for affluent, working professionals – as revealed by statistics from Metrolinx 2015. With more people living in highrises, it's also increasing in density and population.



## THE PRESTIGE EFFECT

(STATS FROM METROLINX 2015)

Total Population

Yonge-Eglinton area:

**27,600**

Area Population

Population Growth (2009-2014)

**17%**

Age 0-14:  
**8%**

Age 65+:  
**12%**

Age 15-64:  
**79%**



**29% OWN**  
**71% RENT**



Average Household  
Income (2015)  
**\$87,000**

### YONGE & EGLINTON POPULATION DENSITY:

**137** Residents per Hectare  
compared to **7.9** Residents per  
Hectare in the GTHA (2015)

### HOUSING TYPE (2015)

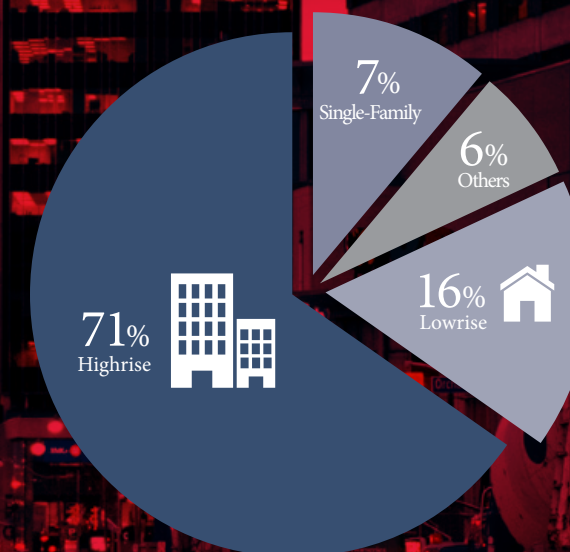

PLAZA®

## THE AFFLUENCE INFLUENCE.

Yonge and Eglinton is self-contained and well-established, surrounded by Georgian-and-Tudor-style homes, peppered with some older, taller buildings. The area has been experiencing massive growth, especially since the LRT became a reality.

Surrounded by Forest Hill, Lawrence Park and Lytton Park, Yonge and Eglinton brushes shoulders with some of the city's most prestigious addresses.

The average household income in the area is an impressive \$87,000.<sup>1</sup>

<sup>1</sup> Stat from Metrolinx 2015



\*Average home price over last 12 months<sup>1</sup>

**RISING RATES OF  
EMPLOYMENT.**



**EMPLOYMENT <sup>1</sup>**

Yonge and Eglinton is the second largest and fastest growing employment centre in Toronto, with the highest density of employment in the city.



Over the last five years, Yonge-Eglinton has grown by **9.8%**, adding **1,550** jobs.

Employment in Yonge-Eglinton Centre is mainly office-related, with **8** out of every **10** jobs in this sector (77.1%).

1. Updated with info from 2015 survey

**WORLD REALTY POINT**  
CLASSIFIED BROKER/AGENT  
Independently Owned & Operated  
www.WorldClassRealtyPoint.com  
(416) 444.7653

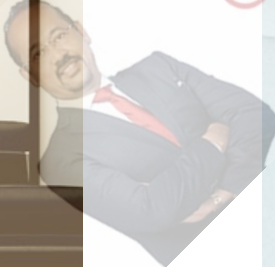

**ZIA ABBAS**  
www.CondoOnly.com



# YONGE-EGLINTON CENTRE A CENTRE OF TRANSFORMATION



## YONGE-EGLINTON CENTRE TRANSFORMATION

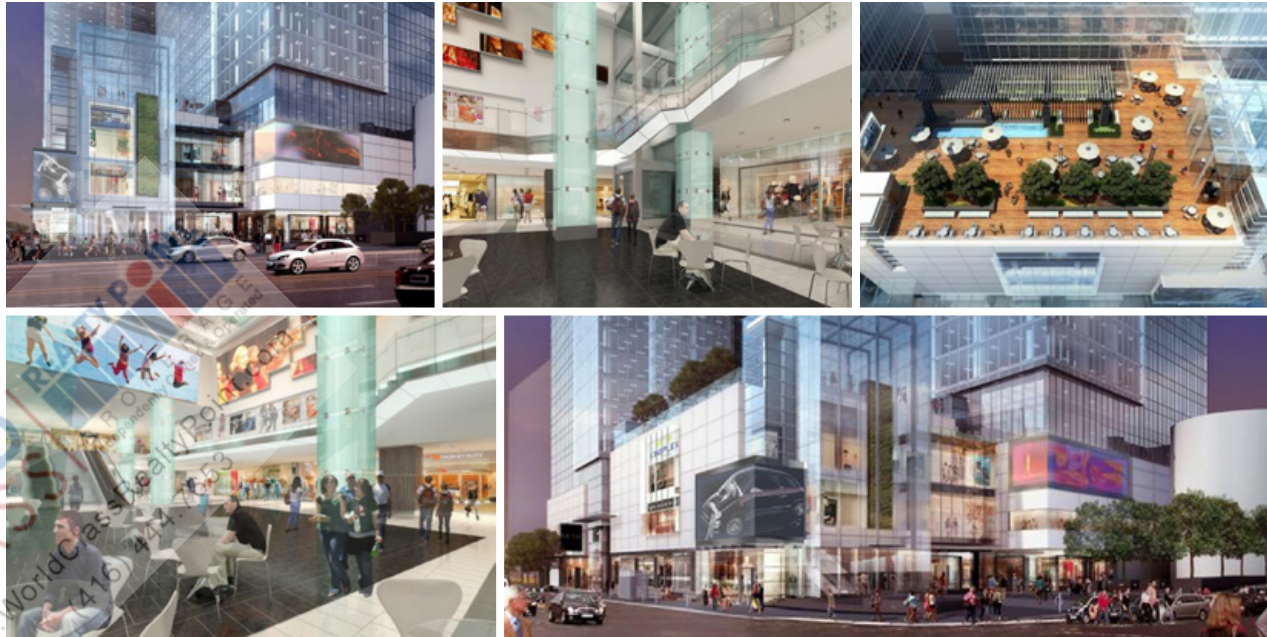

**THE OFFICE SECTOR GREW  
37.5% IN THE LAST  
FIVE YEARS AND 14.2%  
BETWEEN 2012 – 2013**

Currently completing a \$100 million upgrade.

Retail space is being renovated and expanded.

Major retail tenants include Urban Outfitters, Indigo, Metro, Cineplex, LCBO, GoodLife Fitness, Winners, Toys R Us, with prominent corner space anchored by the likes of Sephora.

A total of 12 additional floors to be added to the 2 existing office buildings, providing more employment opportunities.

## MAJOR EMPLOYERS AT YONGE & EGLINTON

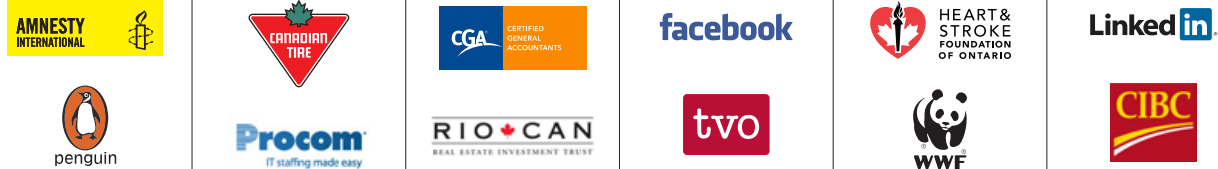

## EDUCATED IMAGINATION.

THE YONGE & EGLINTON NEIGHBOURHOOD  
BOASTS SOME OF THE CITY'S TOP-RANKED  
PUBLIC AND PRIVATE SCHOOLS.

### Secondary Schools

Forest Hill Collegiate Institute

North Toronto Collegiate Institute

Northern Secondary School

### Fraser Institute Rankings

8.5 out of 10

8.6 out of 10; 90% university admission rate

7.4 out of 10

### Elementary Schools

Allenby Jr Public School

Davisville Jr Public School

Eglinton Public School

John Fisher Jr Public School

Oriole Park Jr School

Spectrum Alternative School

### Catholic Schools

Marshall McLuhan Catholic  
Secondary School

St. Monica's Catholic Elementary School

### Private Schools

The Bishop Strachan School

Crescent School

Greenwood College School

Havergal College

St. Clement's Early Learning School

St. Clement's School

TFS – Toronto French School

The York School



ZIA ABBAS  
www.CondoOnly.com



WORLD CLASS REALTY LTD.  
www.WorldClassRealtyPoint.com  
(416) 441-7600



DELICIOUS DISHES.

HOME OF SOME OF THE BEST RESTAURANTS IN TORONTO.

WORLD CLASS BROKERAGE  
www.Worlpoint.com

CLOSE TO **300** WORLD-CLASS RESTAURANTS ARE ALL WITHIN WALKING DISTANCE.



- |                           |                                     |
|---------------------------|-------------------------------------|
| 1. Amore Trattoria        | 14. Green Papaya                    |
| 2. Balsamico              | 15. Il Sogno                        |
| 3. Caffé Demetre          | 16. La Vecchia                      |
| 4. Positano               | 17. North 44                        |
| 5. Chipotle Mexican Grill | 18. Quince Bistro                   |
| 6. CopaCabana             | 19. Sip Wine Bar                    |
| 7. Coquine Restaurant     | 20. Tabule                          |
| 8. Fish Street Market     | 21. Touhenboku Ramen                |
| 9. Five Doors North       | 22. Thorbors Boulangeria Patisserie |
| 10. Fresh                 | 23. Uncle Betty's                   |
| 11. Granite Brewery       | 24. Spacco Restaurant & Bar         |
| 12. Grano Restaurant      | 25. Zucca Trattoria                 |
| 13. Grazie Ristorante     | 26. Cibo Wine Bar                   |



	17		
	LYTTON BLVD.	BLYTHWOOD RD.	
	13	23	
	2	16	
	8	15	
	7	12	
	BRIAR HILL AVE.	SHERWOOD AVE.	
	1	21	
	3,22	18	
	4,11	19	
	14		
	MONTGOMERY AVE.	BROADWAY AVE.	
	Yonge Eglinton Centre	28	
	5,6,20,24,25,27	29,30	
	10	31	
	EGLINTON AVE. W.	32	
		(M)	EGLINTON AVE. E.

WORLD CLASS REALTY POINT BROKERAGE  
 Independently Owned & Operated  
 www.WorldClassRealtyPoint.com  
 (416) 444.7653

## AN ARRAY OF RETAIL OPTIONS.

When it comes to shopping, there's a fine line between "want" and "need". This area provides a retail experience unlike any other, with virtually everything you want/need, all within walking distance.

- |                            |                          |                       |                         |
|----------------------------|--------------------------|-----------------------|-------------------------|
| 1. Lululemon               | 9. Poor Little Rich Girl | 17. Sign of the Skier | 25. Toys 'R' Us         |
| 2. Australia Boot Company  | 10. DeSerres             | 18. Intuition         | 26. L'Occitane          |
| 3. Mendocino               | 11. Restoration Hardware | 19. The Cup Cake Shop | 27. Urban Outfitters    |
| 4. Beddington's Bed & Bath | 12. Drake General Store  | 20. Indigo            | 28. BMV Books           |
| 5. Naturalizer             | 13. Roots                | 21. Sport Chek        | 29. Shopper's Drug Mart |
| 6. Bentley Leather         | 14. Best Buy             | 22. Kiehl's           | 30. Storage Solutions   |
| 7. Olly Shoes              | 15. Running Room         | 23. Sporting Life     | 31. Soft Moc            |
| 8. Club Monaco             | 16. Gap                  | 24. La Senza          | 32. Village Juicery     |

PLAZA®

# PARKS AND RECREATION.



Nature lovers, rejoice. The Yonge and Eglinton neighbourhood has something for every outdoor enthusiast and fitness fanatic. There's 9-hectare Eglinton Park behind the North Toronto Community Centre and Arena, featuring five multipurpose sports fields, four tennis courts, two baseball diamonds, a children's playground, and a wading pool. Minutes north of Eglinton is the Alexander Muir Memorial Gardens, Lawrence Park Tennis and Lawn Bowling Clubs, the Blythwood Ravine Park and Sherwood Park. Or go for a stroll or cycle along the Beltline Trail and interact with nature.

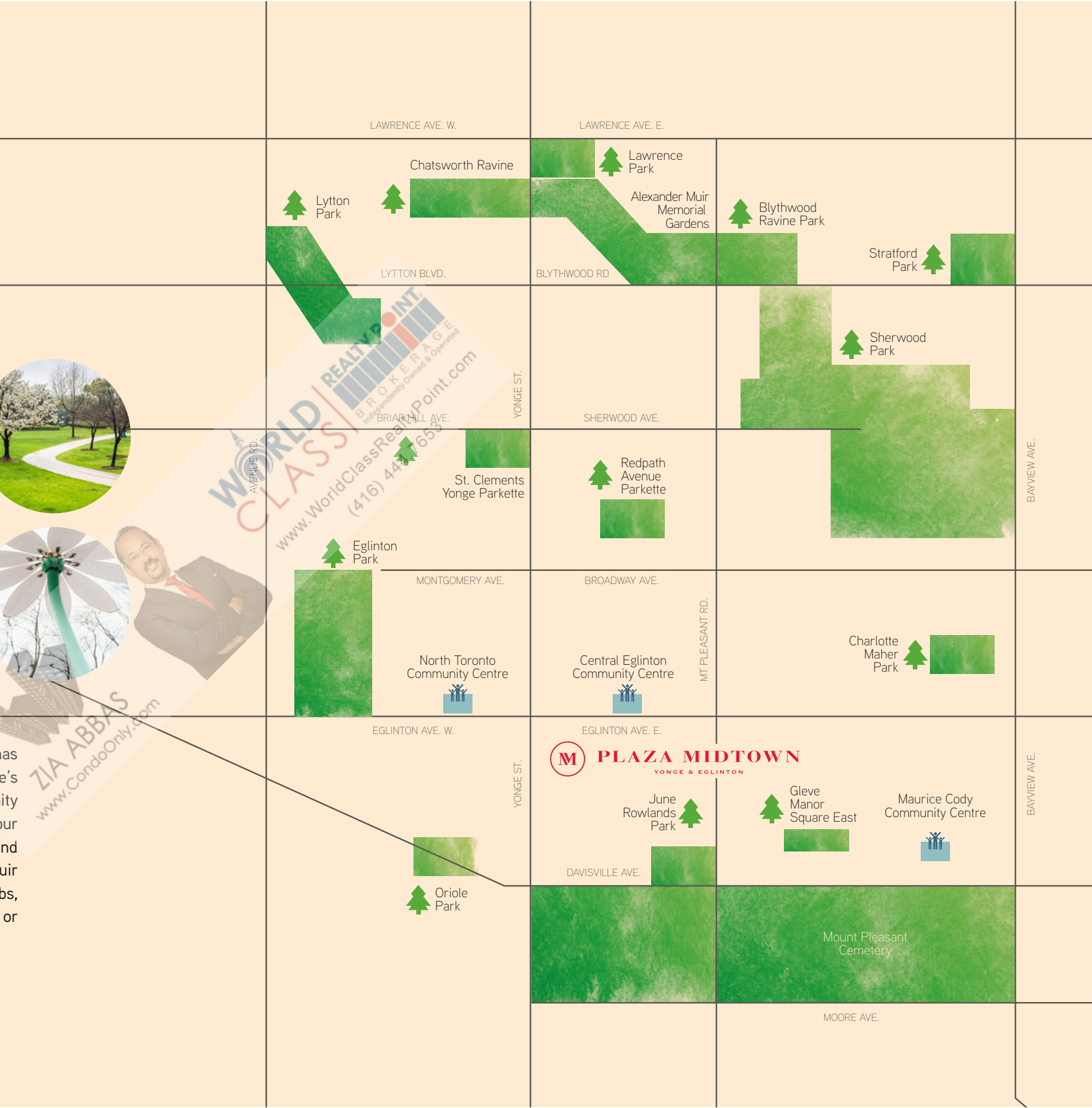



**WORLD CLASS** REALTY POINT  
 BROKERAGE  
 Independently Owned & Operated  
 www.WorldClassRealtyPoint.com  
 (416) 444.7653

**QUALITY SINCE 1982**  
**35**  
**YEARS EXPERIENCE**

For over thirty years, Plaza has made quality its most signature feature. Building in more quality from the beginning is a hallmark of every Plaza community, which has resulted in condominium suites that have greater market value today, and have lasting value for tomorrow. As one of Toronto's most experienced condominium developers, every Plaza condo community strictly adheres to a philosophy of lasting value in architecture, interior design, and materials – so you can be sure your home will be a place of lasting beauty.

**PLAZA®**